

## CAYMAN BRAC LOGHOUSE DRIVE 2.74 ACRES

MLS# 419632 | Cayman Brac East, Cayman Brac, Cayman Islands

CI\$199,000

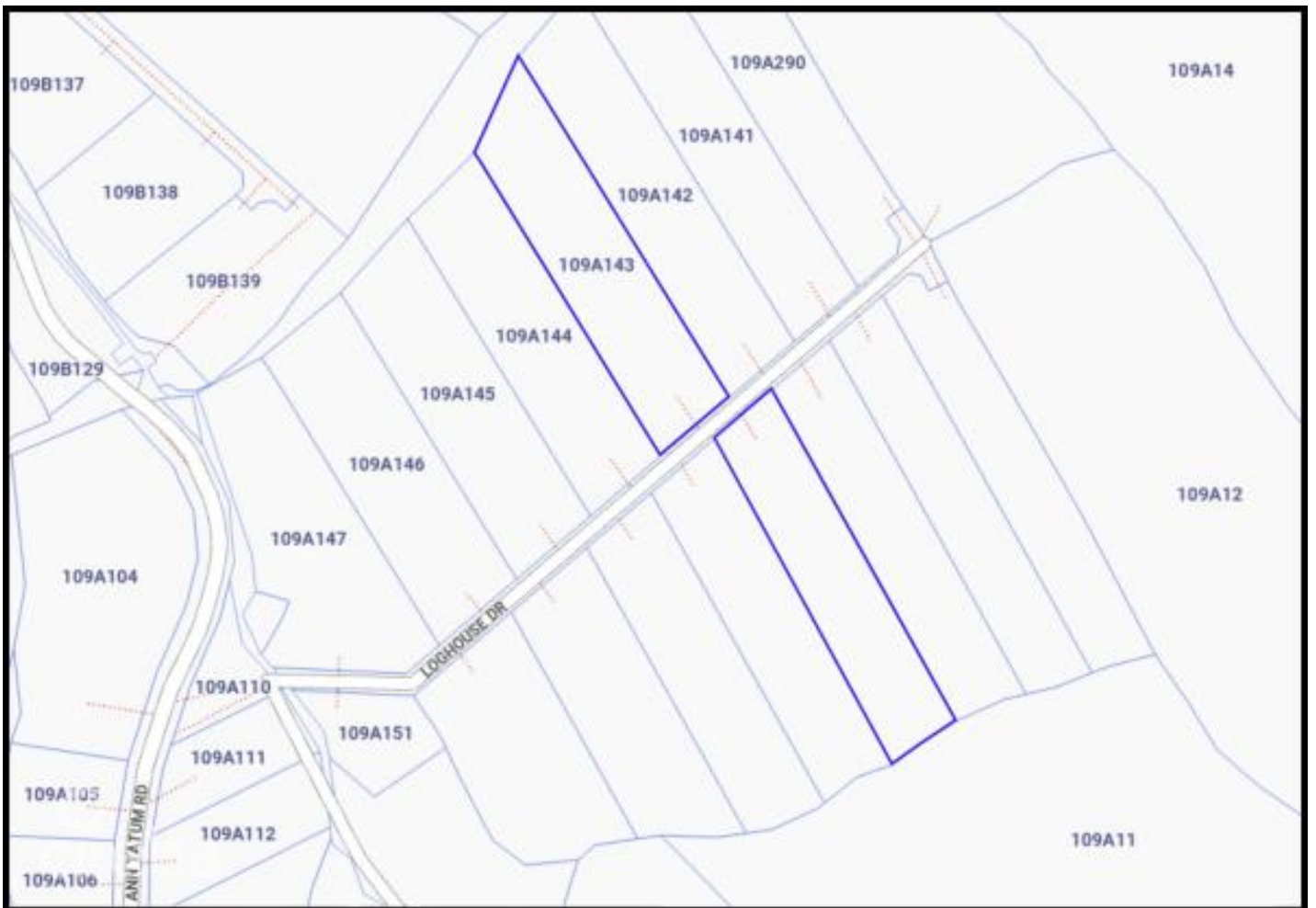

Agent info



**Kraig Hislop**

+1 345 938 7677

[kraig@rainbow.ky](mailto:kraig@rainbow.ky)

---

## Description

Situated on the coveted Bluff Edge of Cayman Brac's peaceful Eastern side, this rare 2.74-acre parcel offers exceptional privacy and captivating beauty. Perched over 110 feet above sea level, the property commands breathtaking, uninterrupted views of the shimmering Caribbean Sea. Its elevated position captures cooling breezes and showcases some of the island's most spectacular sunsets. With its expansive size, seclusion, and sought-after Bluff Edge location, this is the perfect site for a private estate, luxury villa, or investment in one of the Cayman Islands' most dramatic landscapes.

---

## Property Features

Type	Status	View	Listing Type
<b>Land (For Sale)</b>	<b>Current</b>	<b>Water View</b>	<b>Agriculture</b>
Width	Depth	Sq Ft	Block/Parcel
<b>230.00</b>	<b>1025.00</b>	<b>0.00</b>	<b>109A / 143</b>
Area	Acres		
<b>80</b>	<b>2.74</b>		

---

## Additional Features

Soil	Zoning	Road Frontage
<b>Rock</b>	<b>Agriculture/Residential</b>	<b>230</b>