

HEAVY INDUSTRIAL LAND- PRIME 1.062 1 ACRE LOT- RARE FIND!!

MLS# 420934 | W Bay South, Grand Cayman, Cayman Islands

CI\$3,988,888.88

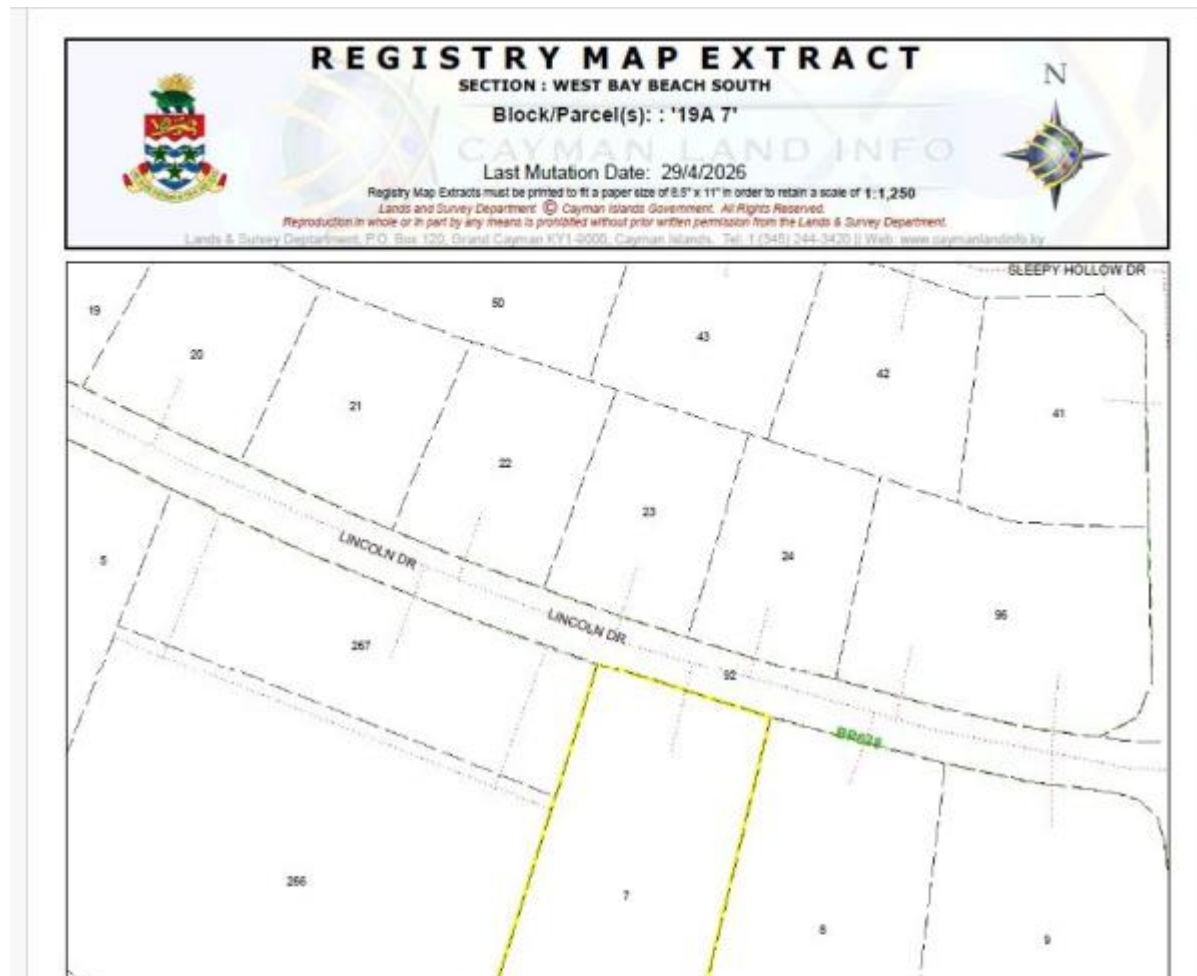

Agent info



Kraig Hislop

+1 345 938 7677

kraig@rainbow.ky

Description

A rare opportunity, an exceptional 1.062-acre heavy-industrial parcel on Lincoln Drive, ideally positioned for investors, developers or owner-operators seeking a strategic, hard-served site in Grand Cayman.

Zoned Heavy Industrial, the lot permits high-value industrial uses including power generation, fuel refining and storage, solid waste disposal, recycling, quarrying/mining and mechanized manufacturing. The property sits within an established industrial and commercial corridor, offering excellent access and operational efficiency for island-wide distribution or heavy-use facilities.

Location highlights

- Central, highly accessible location close to Seven Mile Beach, Camana Bay, Owen Roberts International Airport and George Town
- Immediate proximity to supermarkets, fuel stations, hardware suppliers, restaurants, and other essential services
- Strong logistics advantage for suppliers, contractors and industrial tenants

This is a rare, development-ready industrial holding in a premier commercial node of Grand Cayman, ideal for buyers seeking strategic scale, permitted heavy-use capacity and excellent connectivity. Contact us to review zoning details, site plans, and development potential.

Property Features

Type	Status	View	Listing Type
Land (For Sale)	New	Inland	Industrial
Width	Depth	Sq Ft	Block/Parcel
145.00	310.00	0.00	19A / 7
Area	Acres		
20	1.06		

Additional Features

Soil	Zoning	Road Frontage
Other	Heavy Industrial	135
